

*Tranquil Relaxation
on the Comal River*

From Houston: I-10 take Hwy 46 in Seguin to New Braunfels. Cross under I-35. Go 2 1/4 miles. Turn Left on River Road, Right at 2nd Stop. Entrance on Right

From Austin/San Antonio: I-35. Exit 189. Go West on Loop 337, 2 1/4 miles. Turn Left on River Road. Right at 2nd Stop. Entrance on Right

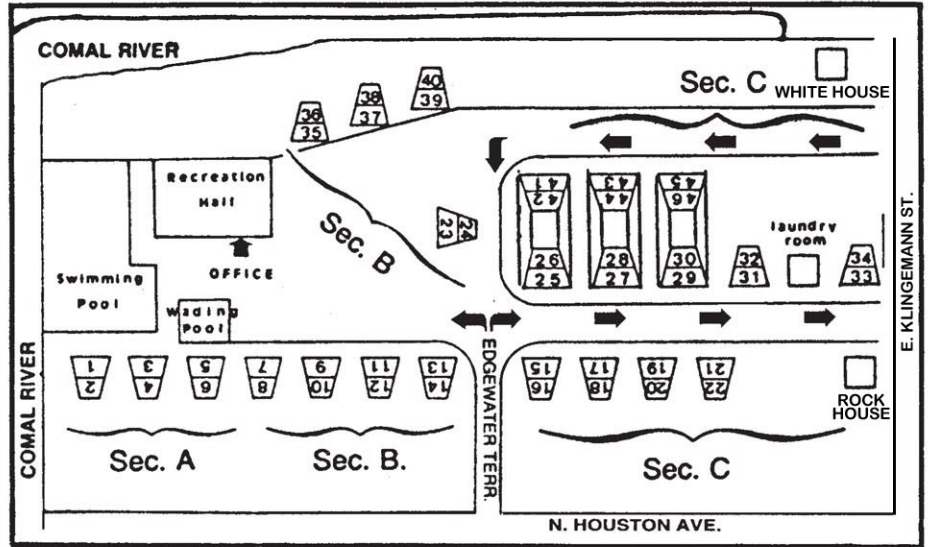

TWO BEDROOM COTTAGE

(lower level)

576 Square Feet

Nos. 1,5,7,9,11,13,15,17,

19, 21, 23, 31, 33, 35, 37, (3 & 39 lower)

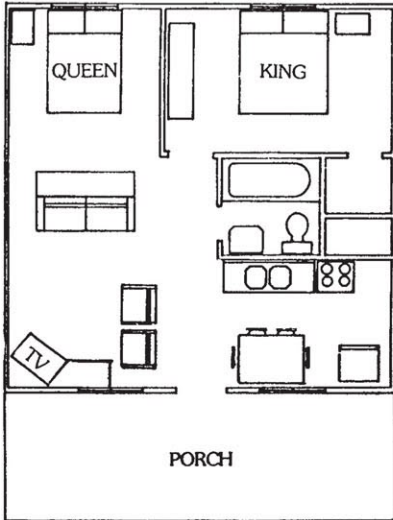

ONE BEDROOM COTTAGE

(upper level)

422 Square feet

Nos. 2, 6, 8, 10, 12, 14, 16, 18,

20, 22, 24, 32, 34, 36, 38, (3 & 39 upper)

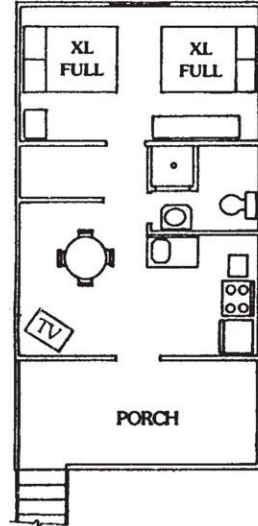

EFFICIENCY COTTAGE

(lower level)

504 Square Feet

Nos. 25, 27, 29, 41, 43, 45

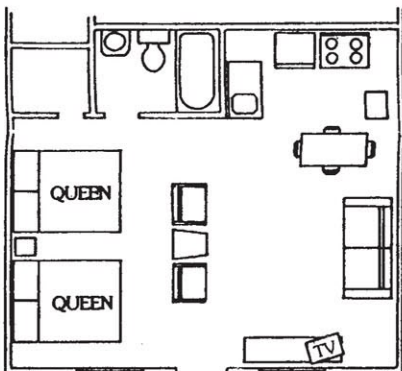

MOTEL TYPE COTTAGE

(upper level)

357 Square Feet

Nos. 26, 28, 30, 42, 44, 46

